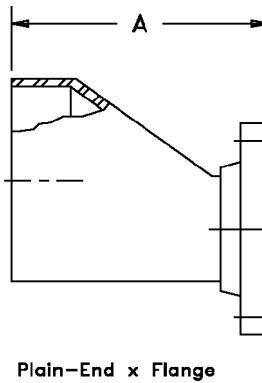
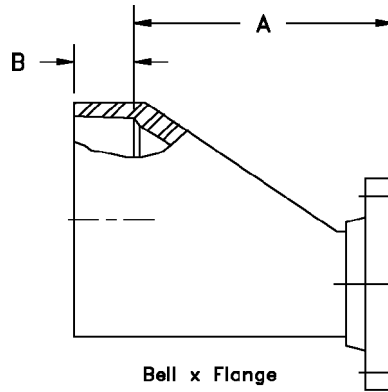



FIG. #56 - Eccentric Tapered Body Reducer, Combination Coupled

Size	"A"	"B"	Wt.
Bell x Flange			
1-1/2 x 1	4.5	1.38	1.0
2 x 1	5.0	1.81	1.2
2 x 1-1/2	5.0	1.81	1.6
2-1/2 x 1-1/2	5.5	1.81	1.8
2-1/2 x 2	5.5	1.81	2.7
3 x 1-1/2	6.0	1.81	2.5
3 x 2	6.0	1.81	2.5
3 x 2-1/2	6.0	1.81	2.5
4 x 2	7.0	1.81	3.5
4 x 2-1/2	7.0	1.81	4.2
4 x 3	7.0	1.81	5.0
6 x 3	9.0	2.25	7.0
6 x 4	9.0	2.25	7.9
6 x 5	9.0	2.25	8.1
8 x 4	11.0	2.50	10.5
8 x 5	11.0	2.50	10.8
8 x 6	11.0	2.50	12.0
10 x 6	12.0	2.75	15.0
10 x 8	12.0	2.75	21.0
12 x 8	14.0	3.00	27.0
12 x 10	14.0	3.00	27.0



Size	"A"	Wt.
Plain End x Flange		
1-1/2 x 1	4.38	1.0
2 x 1	4.88	1.2
2 x 1-1/2	4.88	1.6
2-1/2 x 1-1/2	5.38	1.8
2-1/2 x 2	5.38	2.7
3 x 1-1/2	5.88	2.5
3 x 2	5.88	2.5
3 x 2-1/2	5.88	2.5
4 x 2	6.88	3.5
4 x 2-1/2	6.88	4.2
4 x 3	6.88	5.0
6 x 3	8.88	7.0

Size	"A"	Wt.
Plain End x Flange		
6 x 4	8.88	7.9
6 x 5	8.88	8.1
8 x 4	10.88	10.5
8 x 5	10.88	10.8
8 x 6	10.88	12.0
10 x 6	11.88	15.0
10 x 8	11.88	21.0
12 x 8	13.88	24.0
12 x 10	13.88	27.0
14 x 10	15.75	28.0
14 x 12	15.75	31.0
16 x 12	17.75	52.0

Size	"A"	Wt.
Plain End x Flange		
16 x 14	17.75	60.0
18 x 14	18.75	65.0
18 x 16	18.75	73.0
20 x 16	19.75	80.0
20 x 18	19.75	88.0
24 x 18	23.75	145.0
24 x 20	23.75	155.0

Other sizes and combinations are available. Plain end reducers are available with socket ends for adhesive joining. Please see Fig. #90 for butt and wrap kits for plain end reducers. Bolt and gasket sets are available. Please see Fig. #101.

NO RETURNS ALLOWED