



**Industrial Fiberglass Specialties, Inc.**

521 Kiser Street, Dayton, OH 45404-1641

Phone: (937) 222-9000 • Fax: (937) 222-9020

Email: sales@ifs-frp.com • Web: www.ifs-frp.com

**Product Catalog**

**24 February 2004**

**FIG. #53 - Concentric Tapered Body Reducer, ANSI Flanged**

Size	"A"	Wt.
1-1/2 x 1	4.5	1.5
2 x 1	5.0	1.8
2 x 1-1/2	5.0	2.5
2-1/2 x 1	5.5	2.0
2-1/2 x 1-1/2	5.5	2.9
2-1/2 x 2	5.5	3.5
3 x 1-1/2	6.0	4.0
3 x 2	6.0	6.0
3 x 2-1/2	6.0	7.0
4 x 2	7.0	8.4
4 x 2-1/2	7.0	8.8
4 x 3	7.0	10.0
6 x 3	9.0	13.0
6 x 4	9.0	15.0
6 x 5	9.0	16.0
8 x 4	11.0	22.0
8 x 5	11.0	24.0
8 x 6	11.0	26.0
10 x 6	12.0	30.0
10 x 8	12.0	37.0
12 x 8	14.0	48.0
12 x 10	14.0	54.0
14 x 10	16.0	63.0
14 x 12	16.0	70.0
16 x 12	18.0	82.0
16 x 14	18.0	90.0
18 x 14	19.0	102.0
18 x 16	19.0	110.0
20 x 16	20.0	138.0
20 x 18	20.0	162.0
24 x 18	24.0	204.0
24 x 20	24.0	228.0

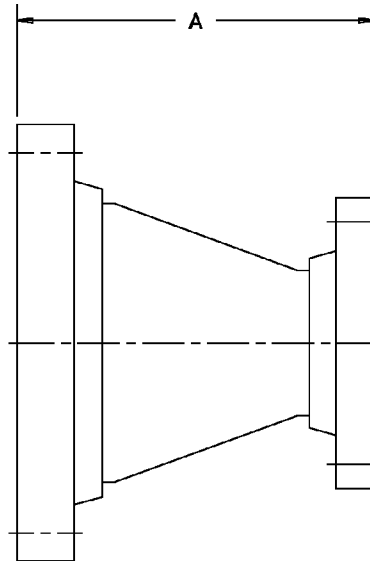

Other sizes and combinations are available. Fittings meet the flange face to flange face dimension of ANSI B16.5, 150 lb. Bolt and gasket sets are available. Please see Fig. #101.