



**Industrial Fiberglass Specialties, Inc.**

521 Kiser Street, Dayton, OH 45404-1641

Phone: (937) 222-9000 • Fax: (937) 222-9020

Email: sales@ifs-frp.com • Web: www.ifs-frp.com

**Product Catalog**

24 February 2004

**FIG. #21-S/21-L - 90 Degree Elbow, Short or Long Radius, Plain End**

Size	"A" Short Radius 21-S	"AA" Long Radius 21-L	Wt.
1/2	N.A.	2.37	0.3
3/4	N.A.	2.67	0.4
1	1.37	3.37	0.7
1-1/2	2.12	3.87	1.0
2	2.87	4.37	1.5
2-1/2	3.00	4.87	1.7
3	3.00	4.50	2.5
4	5.87	6.37	3.8
5	C.F.	C.F.	C.F.
6	7.87	11.37	7.5
8	8.87	13.87	13.0
10	10.87	16.37	20.0
12	11.87	18.87	28.0
14	14.00	21.00	36.0
16	16.00	24.00	46.0
18	18.00	27.00	57.0
20	20.00	30.00	70.0
24	24.00	36.00	93.0
30	30.00	45.00	116.0
36	36.00	54.00	151.0

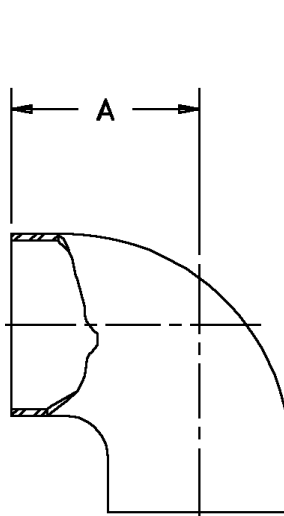

**21-S  
Short Radius**

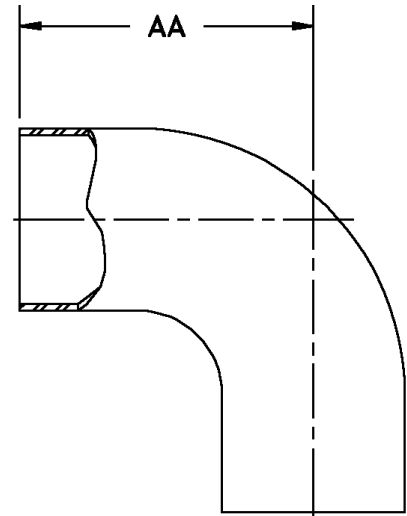

**21-L  
Long Radius**

N.A. - Fitting not available. C.F. - Consult factory for dimensions

Plain-end fittings are designed for butt-and-wrap joining. Butt-and-wrap kits are available, please see Fig. #90. Elbows 1" through 12" are rated for 150 psi. Elbows 14" and larger are rated for 100 psi. Higher pressure ratings are available.

NO RETURNS ALLOWED